

Turbolader Nachrüstätze Verwendungsliste

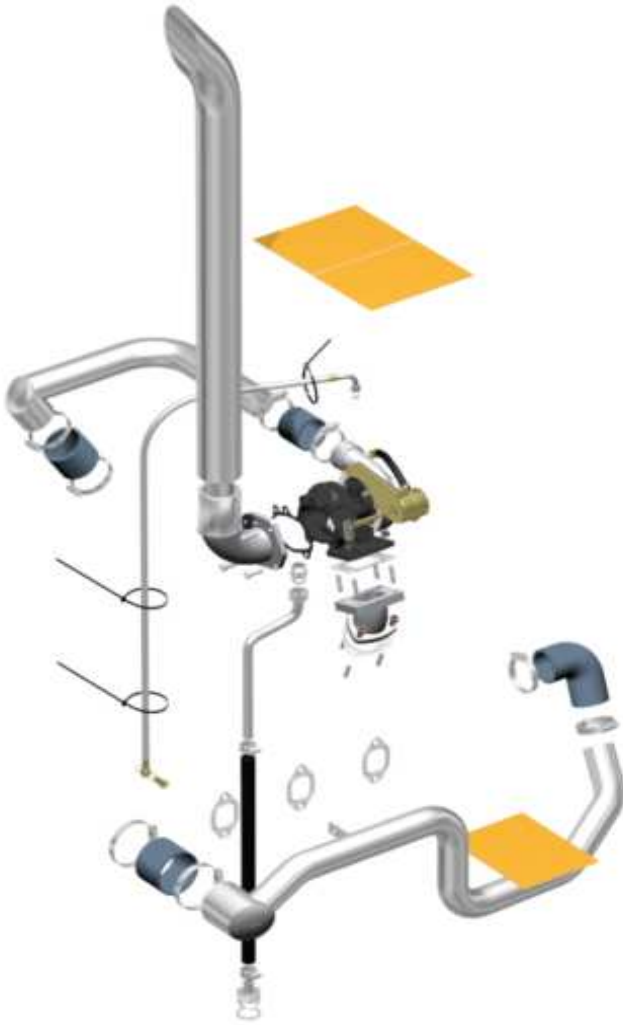

Fortschritt:

E302, E303, E512, E514, ZT-323A.

John Deere:

3040, 3050, 3140, 3350, 3640, 6010SE, 6100, 6506, 6510, 6520, 9910, 9920.

Landini:

Globus 55, Globus 60, Globus 65, Globus 80, Blizzard 65, Globus 70, Blizzard 75, Globus 75, Blizzard 85, Legend 105, Legend 115, 5500, 5830, 5860, 5870, 6550, 6560F/L, 6830, 6860, 6870, 6880, 7550, 7560F/L, 7800, 7830, 7860, 7880, 8550, 8560F/L, 8800, 8830, 8860, 8870, 8880, 10000-II, 10800, 11800, 13000-II, Mythos 110.

Massey Ferguson:

50HX, 250, 253, 254S, 265, 273, 274S, 275, 283, 284S, 285, 290, 293, 294S, 298, 340, 350, 353, 353S, 362, 365, 372, 373, 373S, 374F/S, 375, 377, 377-GTI, 382, 383, 383S, 384F/S, 387, 387-GTI, 390, 393, 393S, 394F/S, 397, 397-GTI, 399, 430, 675, 690, 698, 699, 1004, 1024, 2210, 2230, 3050, 3055FS, 3060, 3080, 3085, 3095, 4225, 4235, 4260, 4270, 4325, 4335, 5425, 5435, 6110, 6120, 6160, 6170, 6260.

NEW / NEU 2006: Massey Ferguson 5425 & 5435

Polytrac:

50S.

Renault:

ARES 610 R/Z, ARES 620 R/Z, TEMIS 610 X/Z.

Steyr:

8100, 8110, 360 Kompakt, 485 Kompakt.

Ursus:

385, 902, 912, 1201, 1204, 1212, 1222, 1224, 4512, 4514.

Valmet/Volvo:

905, T-650.

Zetor:

7211, 7245, 7711, 7745, 8011, 8045, 8111, 8145, 12011, 12045, 12111, 12145.

NEW / NEU 2006:

- *Turbokit for New Holland TL-A series & TD-D ser.*
- *Turbosatz für New Holland TL-A Serie & TD-D Ser.*

NEW / NEU 2007:

- *Turbokit for / Turbosatz für:
New Holland TN85SA & TN85DA,
Case CX1085C & Steyr 360- & 485 Kompakt..*

Nissan:

King Cab, Pick-Up.

Toyota:

HiLux.

Volkswagen:

Taro.

Belarus:

80/82, 500/525, 800/820, 800/860, 900/920.

Case-IH:

485, 495, 495XL, 585XL, 595XL, 640, 685XL, 695XL, 743XL, 745XL, 785XL, 840, 844XL, 845XL, 885XL, 955, 955XL, 956XL, 1055, 1056XL, 1420, 3220, 3230, 4210, 4220, 4230, 5130, CX70, **CX1085C**, JX70U, JX75, JX80, JX80U, **JX1070U**, **JX1080U**, **JX1085C**.

NEW / NEU 2006: Case JX1070U & JX1080U.

New Holland, Fiat & Ford:

45-65S, 50-66S, 55-66S, 56-66S, 60-66, 60-88, 65-66, 65-88, 65-90, 65-93, 65-94, 70-56, 70-66, 70-88, 70-90, 72-93, 72-94, 80-66, 80-88, 80-90, 82-93, 82-94, 90-90, 100-90, 110-90, 115-90, 655C, 680, 780, 1180, 2120, 3430, 3435, 3930, 3935, 4110, 4130, 4135, 4610, 4630, 4635, 4830, 4835, 5030, 5110-III, 5600, 5610, 5610-II, 5610-III, 5635, 5640, 6410, 6600, 6610, 6610-II, 6640, 6700, 6710, 6710-III, 7810, 7810-II, 7840, 7910, 8160, 8200, 8210, 8240, 8260, 8340, 8700, F100, F110, F115, F120, L65, L60, L75, LM410, LM630, LM640, M100, M115, S90, TD75D, TD80D, TD85D, TL70, TL80, TM115, TN55D, TN55S, TN55V, TN60A, TN60SA, TN65D, TN65F, TN65N, TN65S, TN60VA, TN65V, TN75F, TN75FA, TN80F, **TN85SA**, **TN85DA**, TS90, TS115, TW10.

Dieseltechnik-Lindemann

Werner-von-Siemens-Str. 11

24783 Osterröfeld

Germany

Tel: 0049 (0) 4331 / 86 85 0 - 0

Fax: 0049 (0) 4331 / 86 85 0 - 23

Email: Info@Dieseltechnik-Lindemann.de

Web: www.Dieseltechnik-Lindemann.de